

REARVIEW MIRROR REMOVAL/INSTALLATION

B3E091269220W01

1. Remove the covers. (Vehicles with auto wiper system) (See [Covers Removal Note](#).)

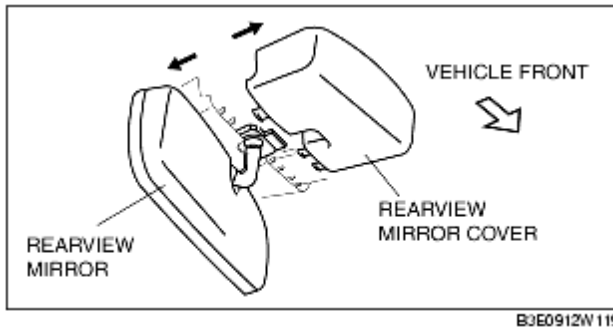

2. Remove the rain sensor. (Vehicles with auto wiper system) (See [RAIN SENSOR REMOVAL/INSTALLATION](#).)
3. Remove the clip, and then remove the rearview mirror upward.

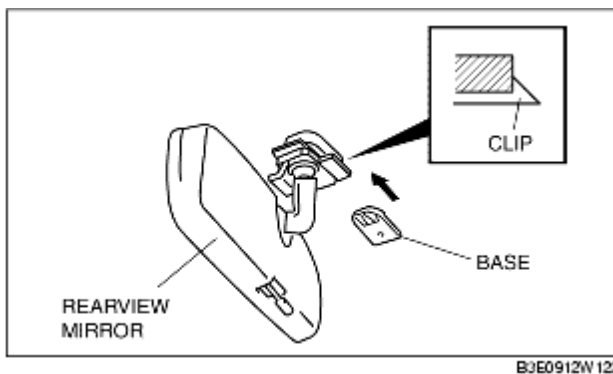

4. Install in the reverse order of removal.

Covers Removal Note

1. Insert a tape-wrapped flathead screwdriver into the notch and pry with the screwdriver in the direction shown by the arrow to remove the covers.

